

INSTRUCTION

OCEAN SKIMMER HIGH 500

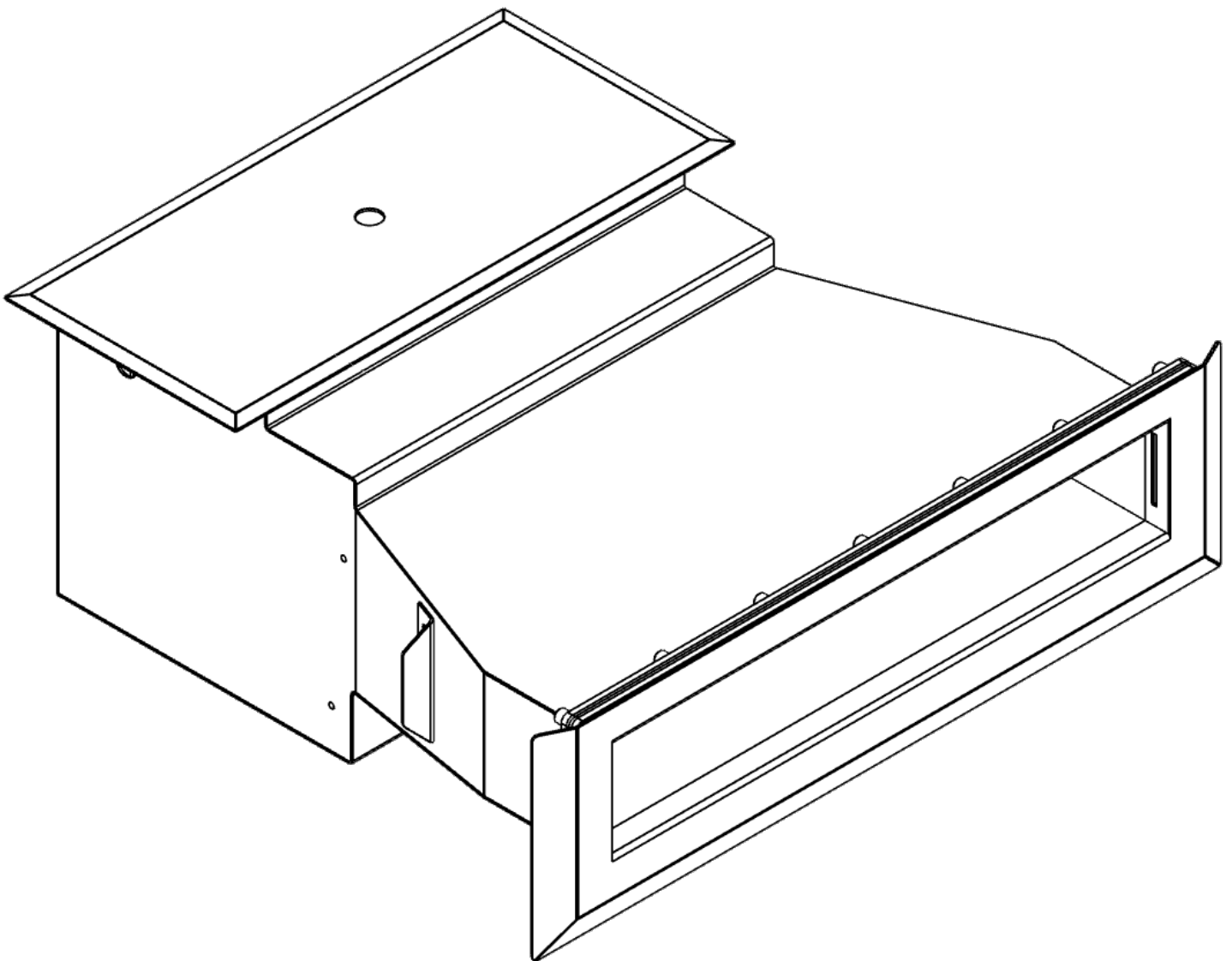

COMPANY DATA:

Peraqua Professional, Water Products GmbH
Handelsstraße 8,
4300 St. Valentin

DATA FOR CONTACT:

phone: +43 7435/58488-0
fax: +43 7435/58488-2009
mail: info@peraqua.com
website: www.peraqua.com

Spis treści

1. GENERAL CAUTION AND SAFETY RULES.....	6
1.1 Product information.....	7
2. LOGISTIC & STORAGE.....	7
3. WATER REQUIREMENTS.....	8
4. TECHNICAL DATA AND ADDITIONAL EQUIPMENT.....	8
4.1 Ocean Skimmer High 500.....	9
4.2 Dimensions.....	10
5. ASSEMBLY INFORMATION.....	11
5.1 Quantity and availability.....	11
5.2 Distance and availability.....	11
5.3 Installation.....	11
6. INSTALLATION.....	12
6.1. Installation in PVC liner and fiberglass pools.....	12
6.1.3 Grounding connection of the device.....	15
7. MAINTENANCE AND REPAIRS.....	16
7.1 Maintenance.....	16
7.2 Repair.....	17
7.2.1 Cleaning of pollution.....	17
7.2.1 Repairing surface damage.....	17
8. ERROR DIAGNOSIS.....	18
9. REPLACEMENTS PARTS.....	19

INTRODUCTION

Dear Customers,

We are happy that you have decided to purchase our product made of the highest quality stainless steel. It is our highest permission to enrich every pool with creative, perfect fitting, affordable and durable pool technology. Our focus is on the maximum ease of use, safety, cleanliness and sustainability of the selected technology for your pool projects.

Please read the following product instructions and keep them for reuse

Instructions contain the necessary information concerning the functioning of the device.

Individual warnings that may occur are marked with individual symbols. These symbols indicate the types of hazard that may occur. It is recommended to strictly follow the instructions and follow the instructions to prevent hazards such as accidents, damage, injuries.



DANGER!

This symbol indicates a danger which may occur and, if not avoided, could result in serious injury, damage to health or death.



WARNING!

points to a potentially dangerous situation which, if not avoided, could result in death or serious injury.



CAUTION!

Indicates a potentially hazardous situation which, if not avoided, could result in minor or minor injury



NOTICE!

It draws attention to a potentially dangerous situation which may lead to material and environmental damage if it is not avoided.



INFORMATION

provides guidance and recommendations for efficient and trouble-free work.

1. GENERAL CAUTION AND SAFETY RULES

We are very pleased with the choice of our brand product. In order for you to enjoy it for a long time, we recommend that you follow the instructions for use and maintenance of the device so that the selected product will last as long as possible.

- All Peraqua products are made of top quality materials. Careful manufacturing guarantees reliability and durability.
- The properties of the product will be maintained for a long period of time if all recommendations for surface maintenance and cleaning are followed.
- Peraqua assumes no warranty and/or liability in the event of misuse or improper installation, assembly or operation.
- The skimmer shall be used exclusively for the discharge of water from swimming pools or bathing areas with associated treatment facilities, in accordance with relevant national or international regulations.
- read and understand the installation and operating instructions carefully before use, assembly and installation.
- Installation, assembly, installation and maintenance may only be performed by trained and qualified personnel



DANGER!

Do not insert any body parts into the skimmer hole. Risk of the skimmer grasping body parts, which may result in health damage and injury.

- When unpacking and installing, be careful of edges and corners. Wear gloves when unpacking to avoid potential injury.
- Before installation, check that the delivered device contains all necessary parts for completeness and check for potential damage.
- When working with stainless steel, use only stainless steel tools specially designed for this purpose.
- During the warranty period, the equipment should not be repaired, tampered with or modified on its own, except with the express consent of the company. In case of failure to comply with the rules, the manufacturer has the right to refuse the warranty rights of the customer.
- Make sure that the surface cleaner is working properly by checking it regularly.
- The surface cleaner must be protected from frost and must not be installed in the immediate vicinity of heat sources with high radiation temperatures. The device itself is approved for a maximum water temperature of 40 and an ambient temperature of 40.

1.1 Product information

Skimmers that comply with technical standards and regulations for public and private swimming pools, operating at home and abroad, are designed and manufactured in accordance with the following regulations.

- **DIN EN 13451 Swimming pool equipment, volume 1 and 3**
Volume 1: General safety tests, requirements and test methods
Volume 3: Additional specific safety requirements and test methods for inlet, outlet and water/air categories
- **DIN EN 15288–1:2008+A1:2010, volume –1:** safety requirements for design
All built-in elements are suitable for concrete and foil pools.
- **DIN EN 16582 Safety requirements and test methods, volume 1 – 3:**
Volume 1: General safety requirements and test methods.
Volume 2: Specific safety requirements and test methods for swimming pools.
Volume 3: Specific safety requirements and test methods for ground pools.
- The skimmer must also be connected to an additional potential equalisation protection if there is a conductive connection to an electrical device (filter pump). This can occur, for example, if the surface cleaner is connected to the filter pump with electrically conductive pipes.
- In case of contact with reinforcement, it is also necessary to include a surface cleaner for additional compensation of protective potential
- With regard to electrical installations in swimming pools, the following points should be noted in: **DIN VDE 0100 Teil 702**

Keep this manual because it contains all important product information.

2. LOGISTIC & STORAGE

Condensation can be formed under the influence of high humidity and changing temperatures for a long time. Local corrosion cannot be excluded. Then the cleaning described in chapter 7 must be carried out. In case of transport, the device must be secured in order to avoid any damage that could result from improper transport.

3. WATER REQUIREMENTS

In swimming pools and bathing areas, water limits such as the following shall not be exceeded or fall below:

Element	Value
Chloride	max. 500 mg/l
free chloride ratio	max. 2 mg/l
pH value	mind. 6,8, max. 8,2
Iron	max. 0,1 mg/l
Copper	max. 0,2 mg/l
Temperature	max. 40 °C

4. TECHNICAL DATA AND ADDITIONAL EQUIPMENT

Overflow pipe	Ø 50
Material	Stainless steel AISI 316
Suction connection to the filter system	2" female thread, 2 ½" male thread connection
Flow rate	7–15 m ³ /h
Dimensions	493 x 374 x 552,4
Weight	17 kg

4.1 Ocean Skimmer High 500

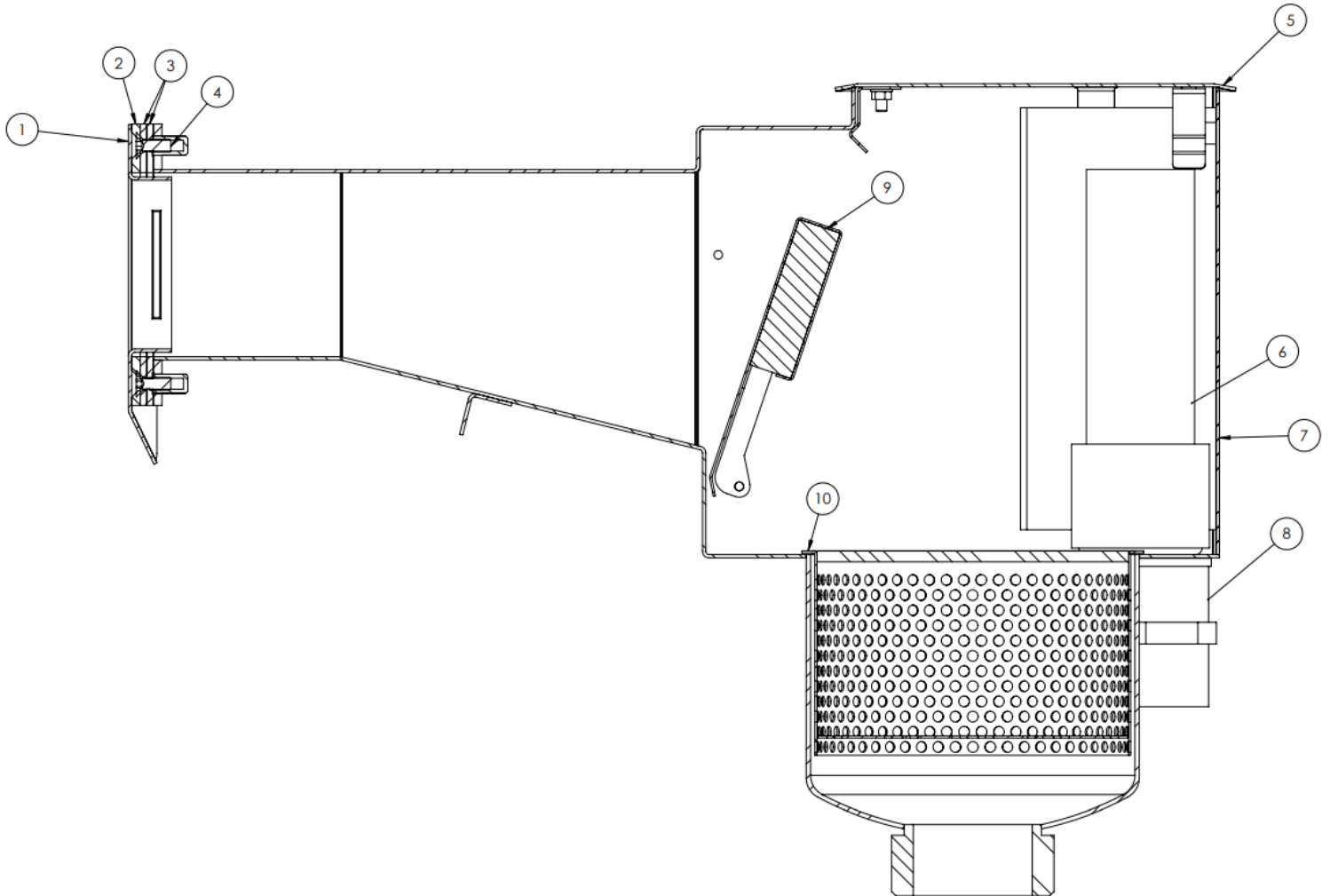

Specification:

1. *Frame SS316*
2. *Flange SS316*
3. *EPDM (2)*
4. *M6x20 SS316 (for GFK Pools M6x30)*
5. *Skimmer cover SS316*
6. *PCV Overflow Pipe D50*
7. *Ocean Skimmer Body High 500 SS316*
8. *PVC Adapter Socket D50*
9. *Floating plate*
10. *Skimmer Basket SS316*

4.2 Dimensions

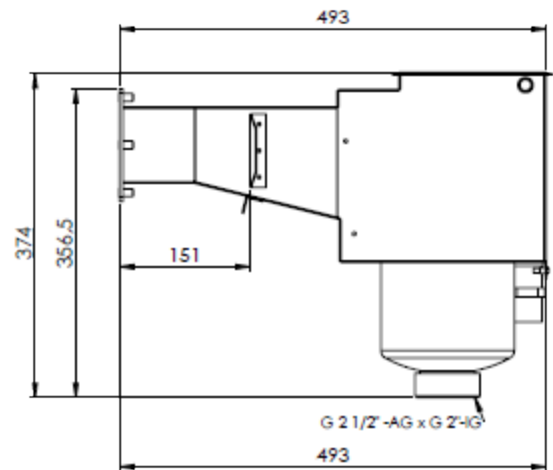
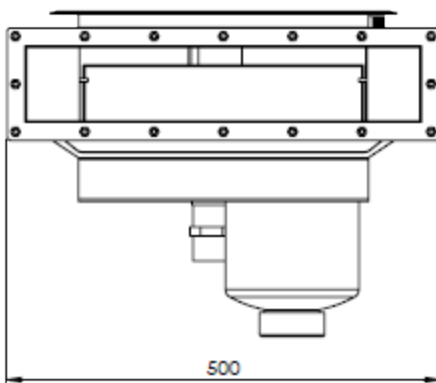
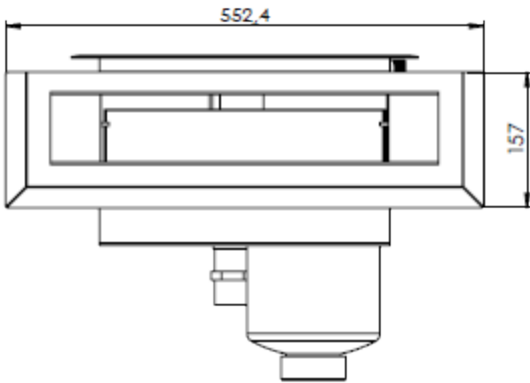
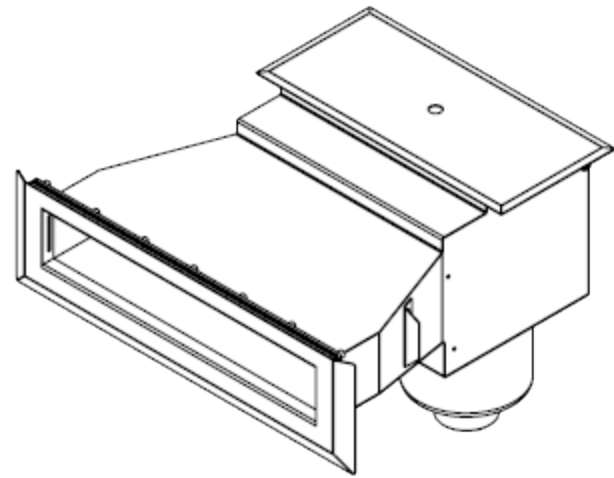
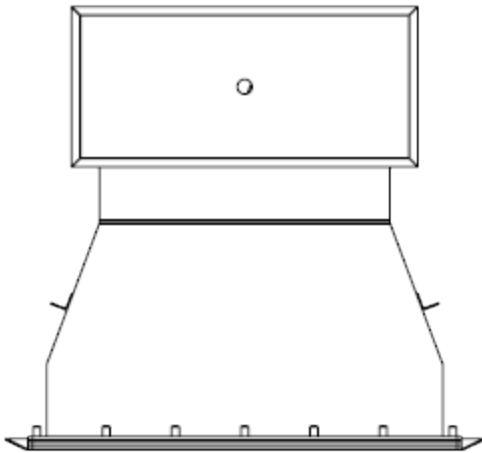

5. ASSEMBLY INFORMATION

5.1 Quantity and availability

Depending on the type and shape of the pool, 1 skimmer per approx. 30 square metres of swimming pool is assumed. The skimmer should be selected in such a way that the selected position ensures a sufficiently good flow in all areas of the pools and no stagnation is created.

For open-air bathing and swimming pools, the surface cleaners should always be positioned with the opening towards the main wind direction to help clean the water surface.

5.2 Distance and availability

Skimmer equipment requires a lot of space and safe access in the pool area. The area must under no circumstances be obstructed or blocked. The recommended water level in the skimmer is indicated on the pattern

5.3 Installation

To ensure an even flow through the pool, the floor main drain connection should be connected to a common suction pipe. It is recommended to use a two-way valve with a reducer, which will simplify the installation and regulation process.

6. INSTALLATION

6.1. Installation in PVC liner and fiberglass pools.



Before starting the installation, it is necessary to protect yourself with personal protective equipment and appropriate tools necessary to install the skimmer in the PVC liner.

Before starting the installation, make sure that the skimmer contains all the parts shown in the picture.

When the skimmer is fully delivered prior to installation, unscrew the skimmer, remove the cover and frame with gaskets and a flange.

Then place the skimmer body in the pool wall so that water can be removed from a certain level. After the body has been installed, the skimmer cover must be mounted.

Finally, place the EPDM so that there is a cut film between them, press the EPDM against the flange and tighten them with the screws included in the kit. At the very end, install the skimmer frame SS316 by pressing it against the skimmer hole.

6.1.2 Installation diagram

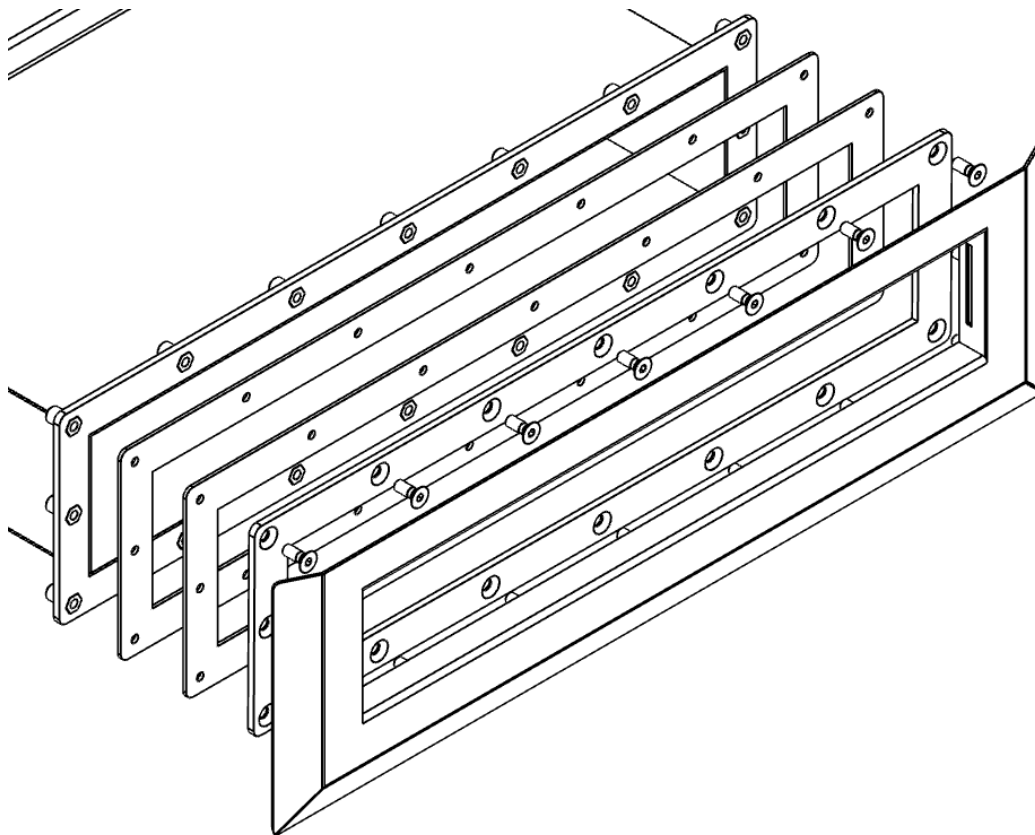

First, pull out the frame by catching it and dynamically pulling it out.

Then unscrew the screws with an Allen key. Then remove the flange and two EPDM gaskets in turn.

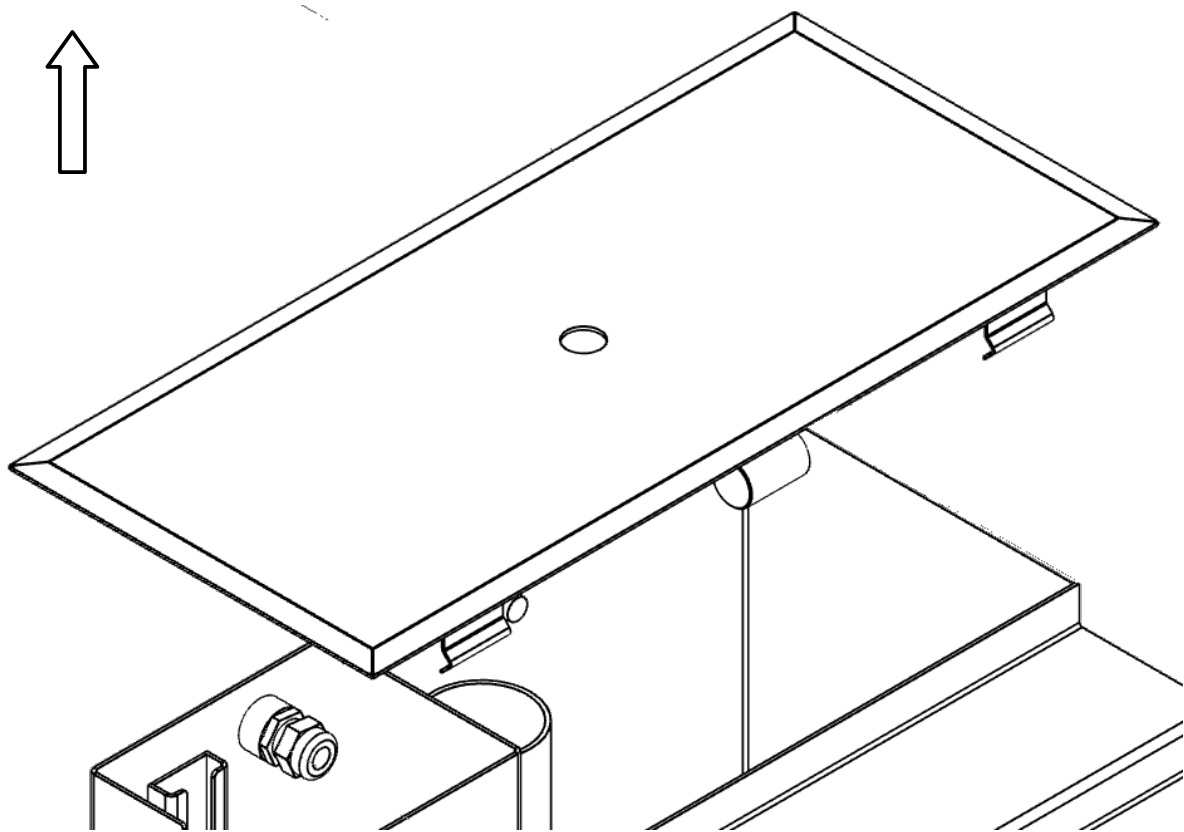

Pull the top skimmer cover out of the body

PERAQUA®

pooled family pleasure

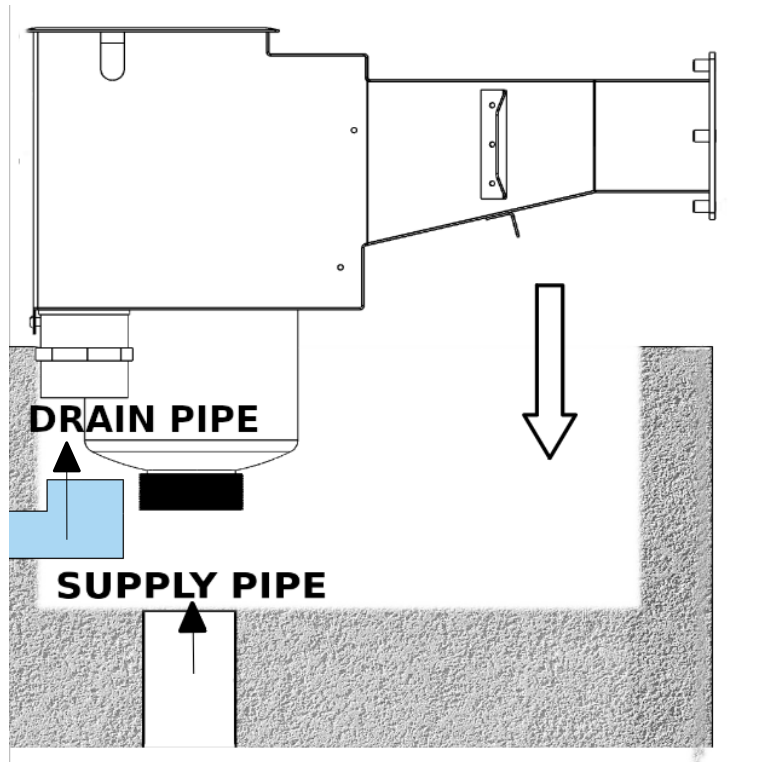

In a properly prepared place for mounting the Skimmer, place the element by screwing the inlet pipe to the 2" female or 2 1/2" male thread connection of the skimmer. Also connect the PVC pipe to the drain pipe

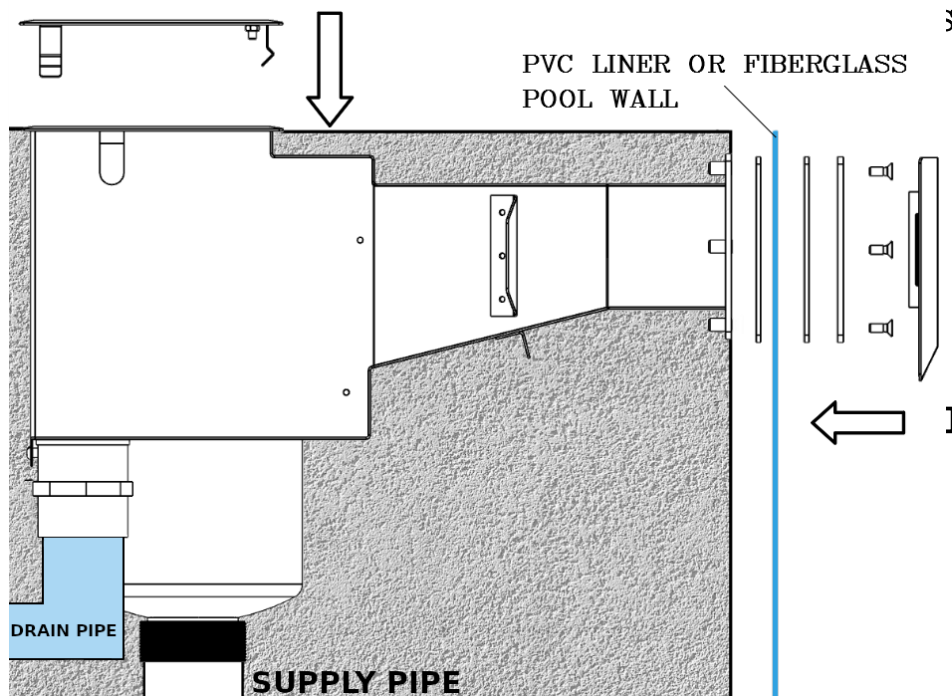

After connecting to the inlet pipe, put the skimmer cover on top. When cutting the liner, make sure that it is between the two EPDM gaskets and then press the flange SS316 against the front of the skimmer using the Allen screws included in the kit. Finally, press the SS316 frame forward so that it is not possible to disconnect from the rest of the skimmer.

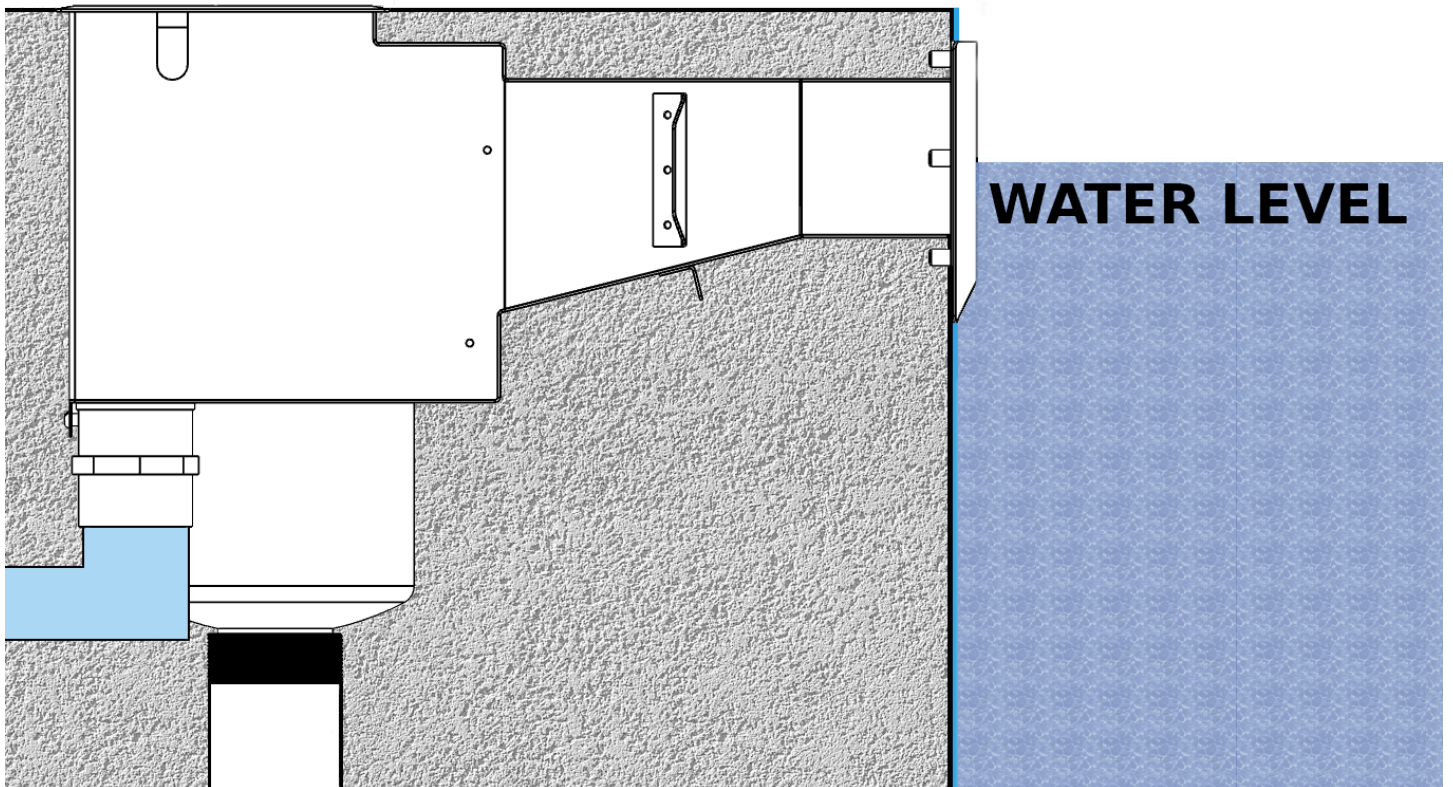

Diagram showing a correctly mounted skimmer in the pool wall.

6.1.3 Grounding connection of the device



When connecting to electrically conductive equipment, place a grounding wire between the two washers and nuts on the pin. The DIN VDE 0100 Volume 702 standard for electrical installation in swimming pools must be observed.

The device should always be earthed regardless of whether it is connected to electrical equipment or not

7. MAINTENANCE AND REPAIRS

7.1 Maintenance



CAUTION!

During maintenance and care work, all pumps must be switched off so that no suction is possible.

It is very important not to damage the texture of the ground or polished surface when cleaning products made of stainless steel. The use of pickling agents and mechanical tools for surface cleaning can lead to a loss of anti-corrosion properties. Do not bring carbon steel into contact with stainless steel. Depending on the type and concentration of the substance in the water, pink spots may appear

These areas can be treated quickly and easily with a special cleaning and polishing pad. The limits for chlorides must be observed for the correct operation of stainless steel components:

max. chloride (Cl) content in water up to 30°C is 500 mg / l or 0,08 % salt

The manufacturer shall not be liable for damage caused by exceeding the maximum chloride content of the pool.

Check the suction basket inside the skimmer regularly and clean it if there is visible dirt.

In indoor swimming pools there are higher concentrations of substances that can cause corrosion, so it is recommended to clean the pool more often.

If possible, we recommend a maintenance contract with your local pool cleaning specialist.



STAINLESS STEEL SHOULD **NOT BE USED** FOR CLEANING:

- products for mortar removal
- diluted hydrochloric acid
- bleaches
- silver cleaners
- carbon steel wire brushes
- purifying wool
- steel scrubbing cushions



FOR CLEANING STAINLESS STEEL IT IS **RECOMMENDED TO USE:**

- fabrics
- chamois leather
- nylon sponge

7.2 Repair



CAUTION!

Personal protective equipment must be used before removing dirt and contamination from the steel surface.

7.2.1 Cleaning of pollution

type of pollution	cleaning products
fingerprints	soapy water or detergent, chloride-free glass cleaners
limescale	solution of $\frac{1}{4}$ vinegar and $\frac{3}{4}$ hot water
oils and lubricants	alcohol-based products (including methyl alcohol and isopropyl alcohol) solvents, e.g. acetone, cleaning agents for chromium plated parts
paints	paint strippers, based on alkali compounds or solvents
cement and mortar	water with a small amount of vinegar at an early stage, in the case of older pollutants – a solution containing a small amount of phosphoric acid, followed by water (preferably demineralised)
iron particles from tools or contact with structural steel	at an early stage – mechanically, in the case of pits – etching and passivation pastes

7.2.1 Repairing surface damage

type of damage	method of repair
minor scratches	use a polishing agent (for stainless steel or chromium) with a soft cloth, suede leather or nylon sponge
deeper scratches	use the non-wovens for stainless steel together with water, then apply polishing agent as follows to restore shine
greater damage, cavities in the material	larger damages can be repaired only by a specialist through the use of equipment and abrasives for stainless steel, material losses require locksmith's and welding interventions and restoration of the passive layer

8. ERROR DIAGNOSIS



ATTENTION!

maintenance and repair work may only be carried out by trained and approved technical personnel.

Error	Possible cause	Solution
Poor quality of water	floating sheet metal does not move	move the sheet forward and backward
	suction basket full of dirt	empty the suction hopper from dirt
	the skimmer shut-off valve choked too much	open the shut-off valve more
Too high a water level	water refilling has not been switched off	horizontal electrode, float valve, electromagnetic valve
	blocked overflow	clean the overflow and check the permeability of the pipe
Too small a water level	water refilling shall not be activated	horizontal electrode, float valve, electromagnetic valve

9. REPLACEMENTS PARTS

FLOATING PLATE

No.

material: AISI 316

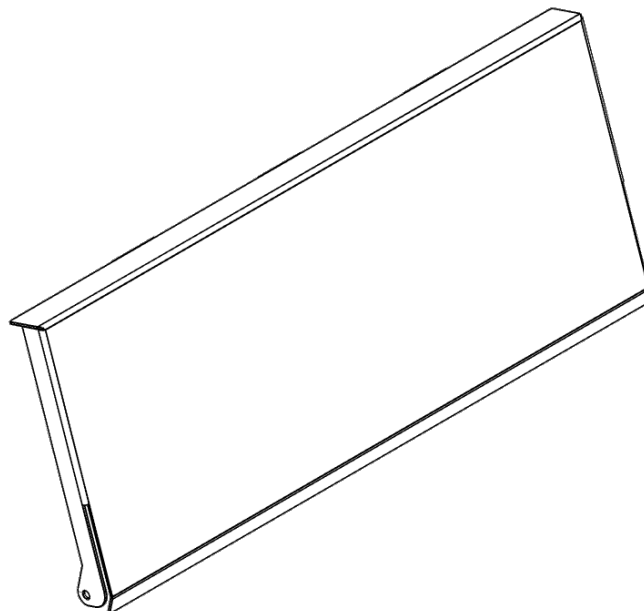

SKIMMER FRAME

No.

material: AISI 316

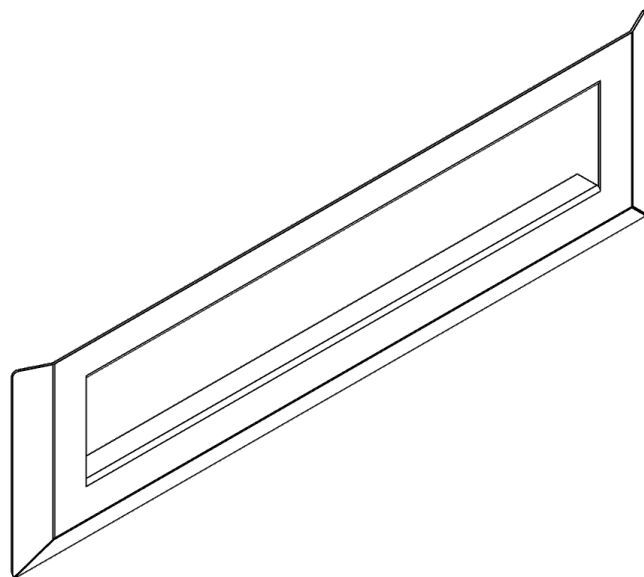

SKIMMER COVER

No.

material: AISI 316

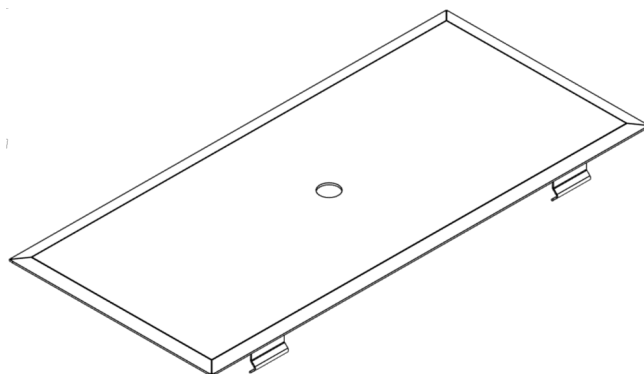

PERAQUA®

pooled family pleasure

FLANGE

No.

material: AISI 316

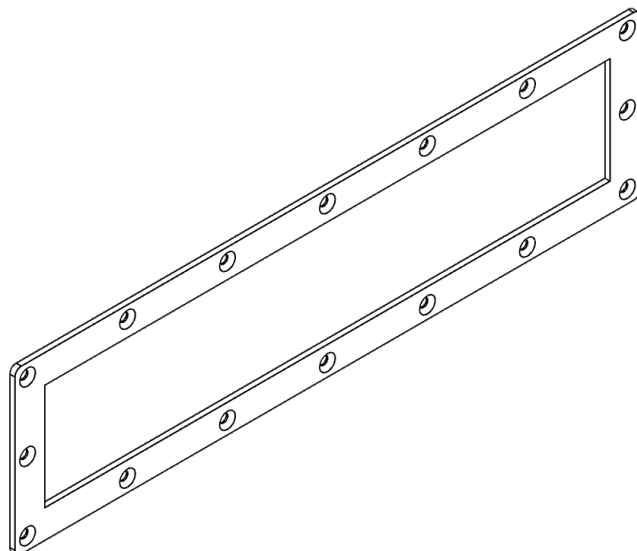

EPDM GASKET (2)

No.

material: EPDM

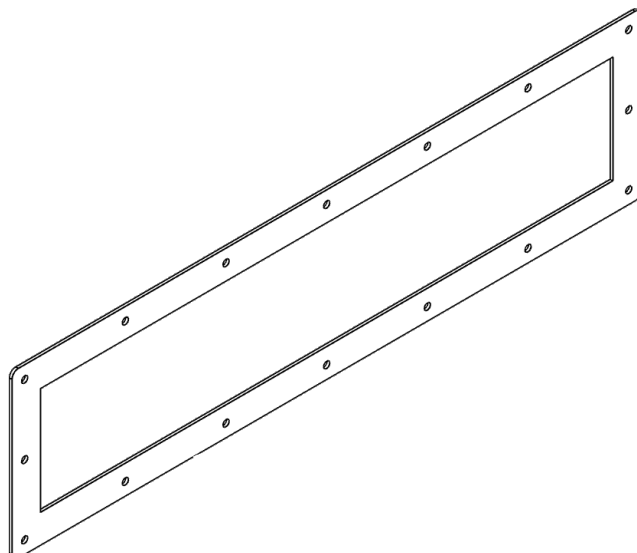

SKIMMER BASKET

No.

material: AISI 316

